

This document has been copied and made available for the purpose of the planning process as set out in the Planning and Environment Act 1987. The information must not be used for any other purpose.

By taking a copy of this document you acknowledge and agree that you will only use the document for the purpose specified above and that any dissemination, distribution or copying of this document is strictly prohibited.

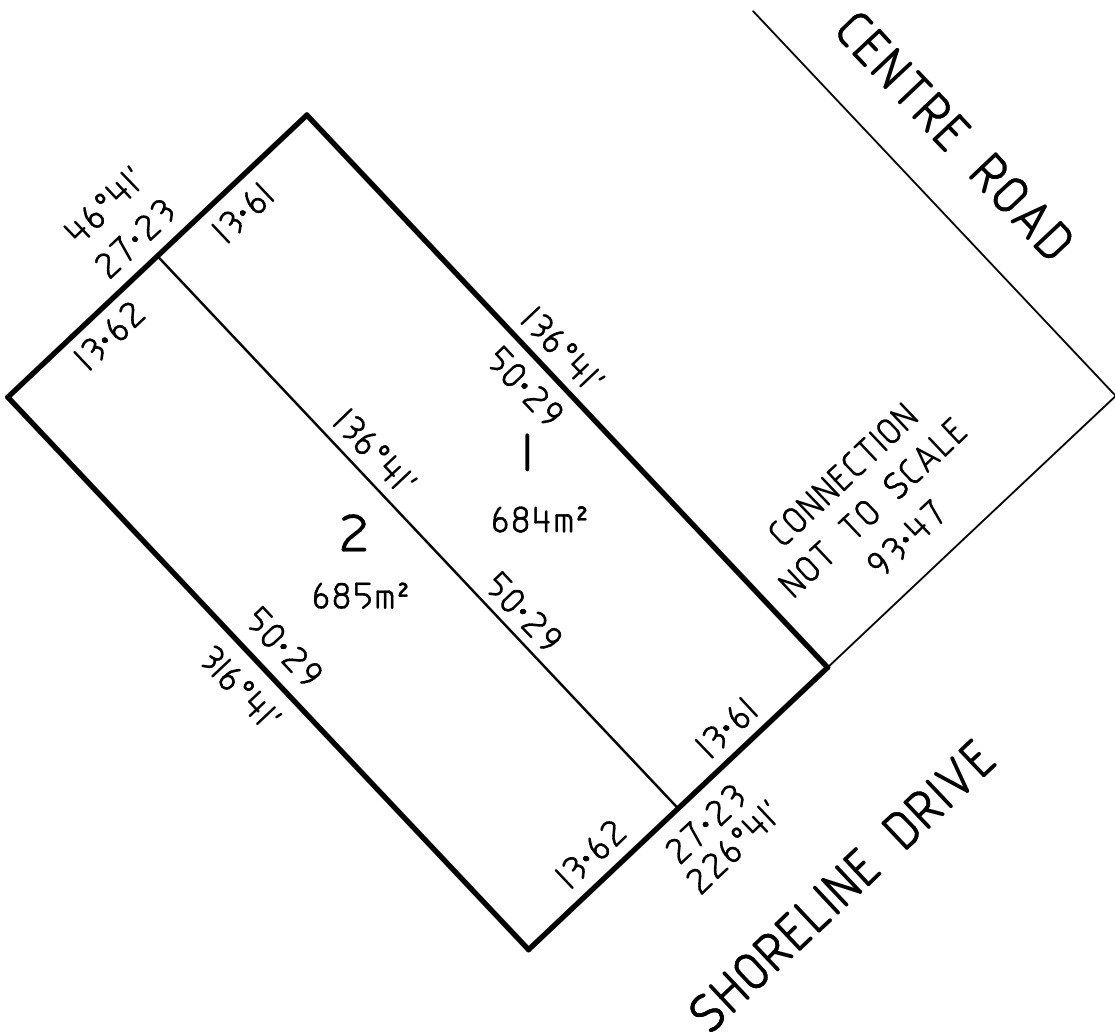

SCALE: 1:500



LENGTHS ARE IN METRES

		PROPOSED SUBDIVISION	
		DAVID NOLAN	
		9 SHORELINE DRIVE SEASPRAY 3851	
		REF 814	VERSION 1
		PLAN 1	
C:\t_data\814_proposedpro.pro			

NOTES

C/T V. 12253 F.692
LOT 2 PS812863 J