

LEGEND

- Proposed subdivision boundary (approx.)
- Proposed DPO boundary (approx.)
- Proposed area of development plan - Stage 01
- Existing / approved subdivision - Future Stages
- Existing road network
- Existing pedestrian path

First floor plan (38-50 Macarthur Street - Thexton Smith)
please refer to Architectural Drawings

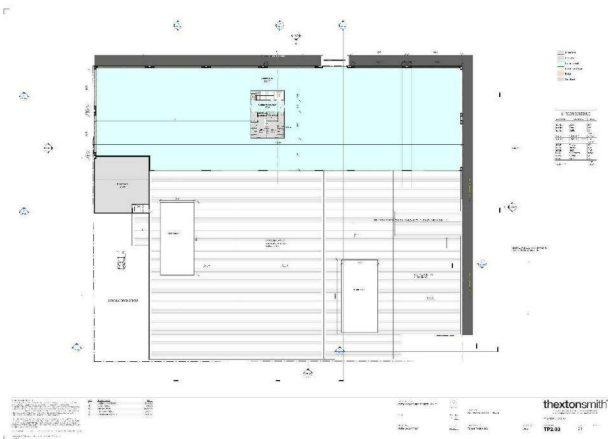

Basement carpark plan (38-50 Macarthur Street - Thexton Smith)
please refer to Architectural Drawings

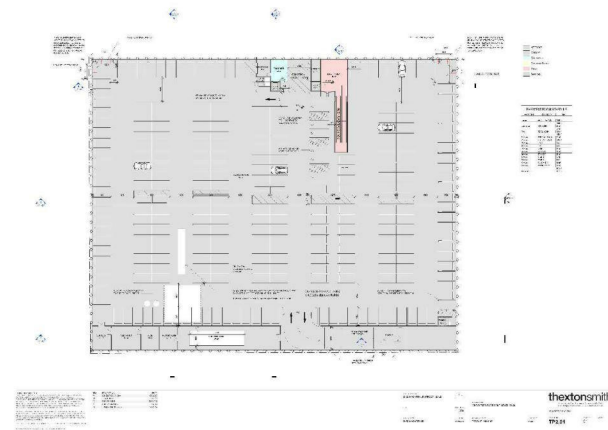

- Notes**
- This plan is indicative only and is intended for discussion purposes only
 - Please refer to Architectural plans for further details and dimensions
 - This plan is subject to Council Approval
 - his plan boundaries are based on VIC map data only are subject to a re establishment survey
 - All dimensions and areas are subject to survey and final computations
 - Arc dimensions shown are the length of arc (not chord)

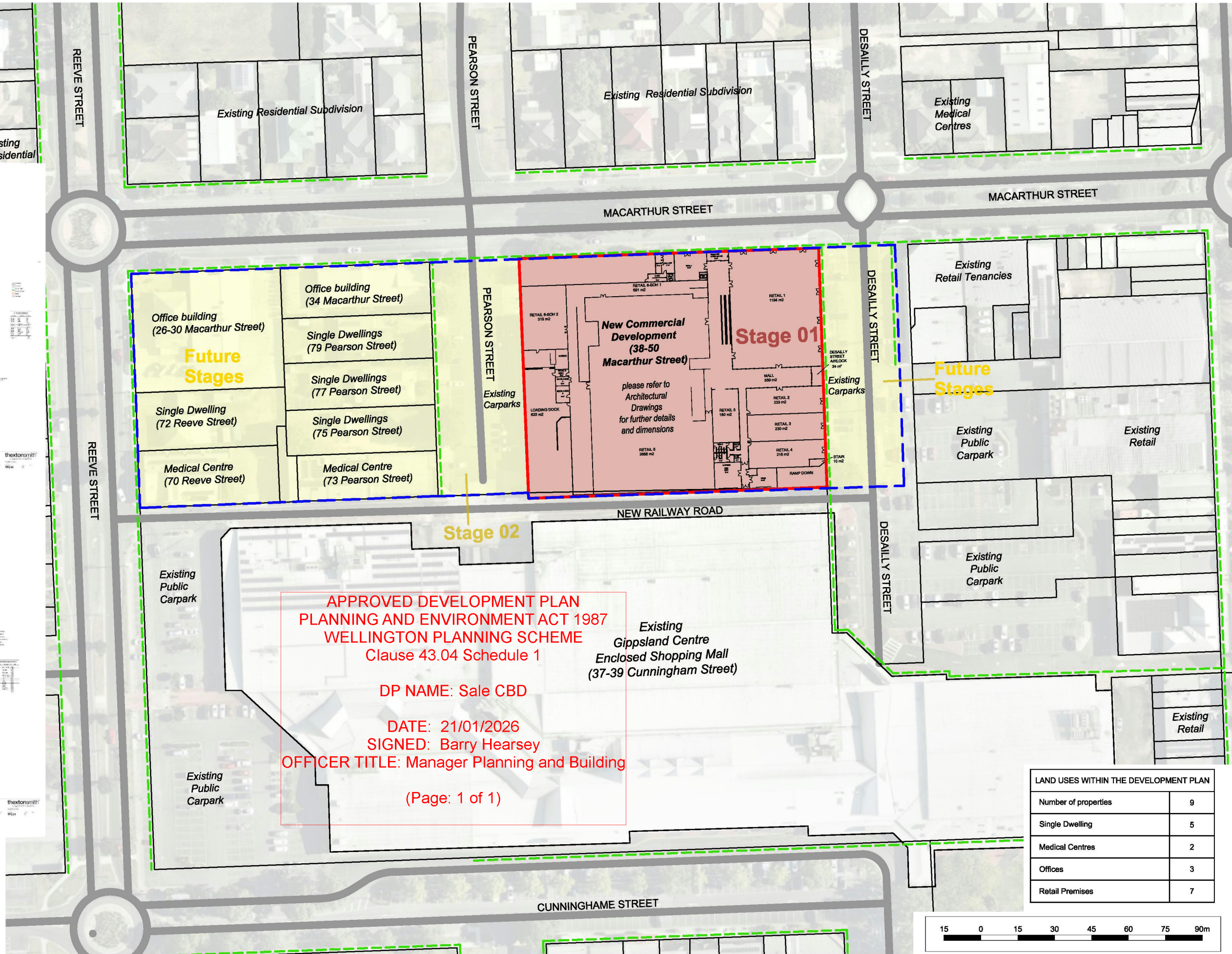

APPROVED DEVELOPMENT PLAN
PLANNING AND ENVIRONMENT ACT 1987
WELLINGTON PLANNING SCHEME
Clause 43.04 Schedule 1

DP NAME: Sale CBD

DATE: 21/01/2026
SIGNED: Barry Hearsey
OFFICER TITLE: Manager Planning and Building

(Page: 1 of 1)

LAND USES WITHIN THE DEVELOPMENT PLAN	
Number of properties	9
Single Dwelling	5
Medical Centres	2
Offices	3
Retail Premises	7

